

SpecFive Relay

User Guide



Thank you for ordering your SpecFiveRelay from SpecFive. Here are the instructions to get you connected to your new device and join the mesh.

WARNING: WARNING: DO NOT POWER ON YOUR SPECFIVE RELAY UNTIL YOU HAVE CONNECTED THE ANTENNA. POWERING THE SPECFIVE RELAY WITHOUT THE ANTENNA CONNECTED CAN CAUSE DAMAGE TO THE BOARD.

Mounting Considerations:

- Line of Sight is very important to achieve long range communications. Obstructions like buildings, trees and topography will limit your range. Mounting your SpecFive Relay high above obstructions is best.
- Solar Panel Direction: For maximum efficiency, solar panels should ideally face true south (not magnetic south) in most locations in the continental US with the Panel tilted 15-40 Degrees from horizontal.
- Your SpecFive Relay should be attached to a pole with a diameter of 1-3 inches.

Setup:

1. Slip the Antenna through the clamp on the side of the SpecFive Relay. The Teeth on the Clamp need to engage with the 2 grooves in the aluminum base of the Antenna. Use a 10mm wrench to tighten the U-Bolt until the Antenna has no movement. If you overtighten the U-bolt you will deform the mounting arm of your SpecFive Relay.

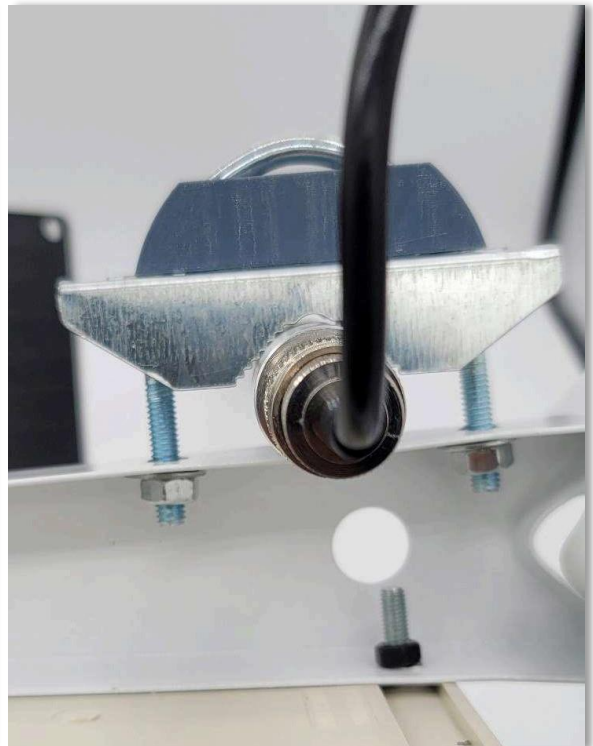

2. Connect the Antenna extension cable to the base of the Antenna.
3. Remove the 4 Screws from the Water-proof Box with a Phillips Head Screwdriver to remove the cover and access the battery connection.



4. The battery is not connected for shipping. Connect the battery cable to the larger White Connector on the board. The Red(positive) Battery Lead should be closest to the center of the board.



Once the battery is connected the SpecFive Relay will be powered on as there is no power switch. Please be mindful that the battery will drain when it is connected to the board without 5 volt Power input from the USB, either from an external power source or the provided Solar panel.

5. Reinstall the Cover, ensuring that the gasket is still in place.
6. Install the Solar Panel to the tilting bracket using the supplied screw in the back of the solar panel. Tighten with a 10mm wrench.



7. Connect the USB cable coming out of the Waterproof Box to the USB cable of the Solar Panel.

**Your SpecFive Relay is now
ready to mount to your pole.**

Configuration:

Your SpecFive Relay is set up as a "Repeater" in the Meshtastic firmware. You can connect to your SpecFive Relay over Bluetooth using the Meshtastic App.

1. Download and install the Meshtastic App from the Apple App Store or Google Play Store



2. Turn on your Phone or Tablet's Bluetooth and open the Meshtastic app.
3. Connect new Device:

Android

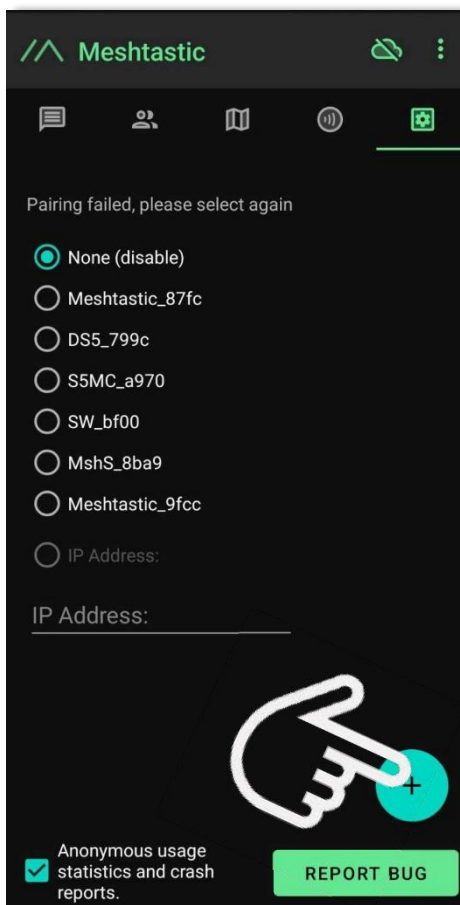

Apple

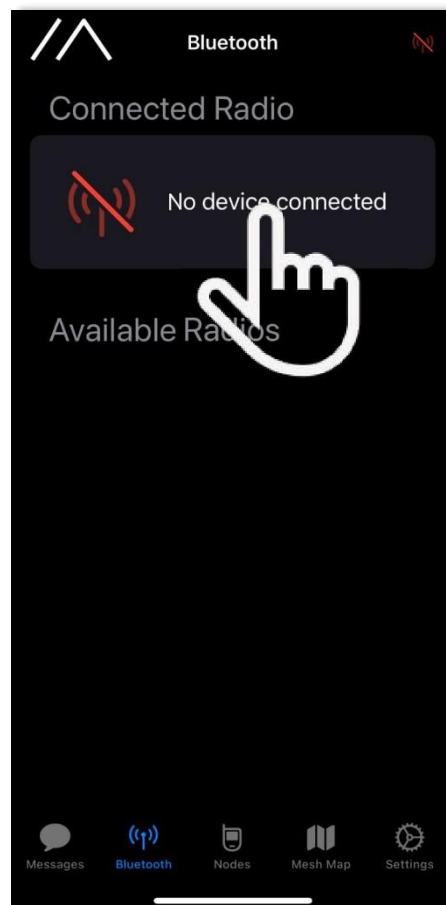

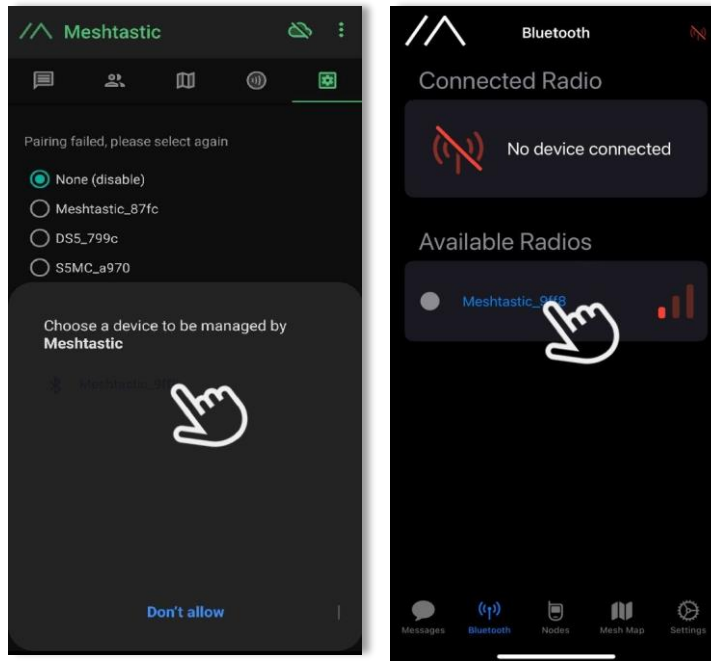

The device PIN is: 123456

4. To use your phone/tablet's location for the location of your device:

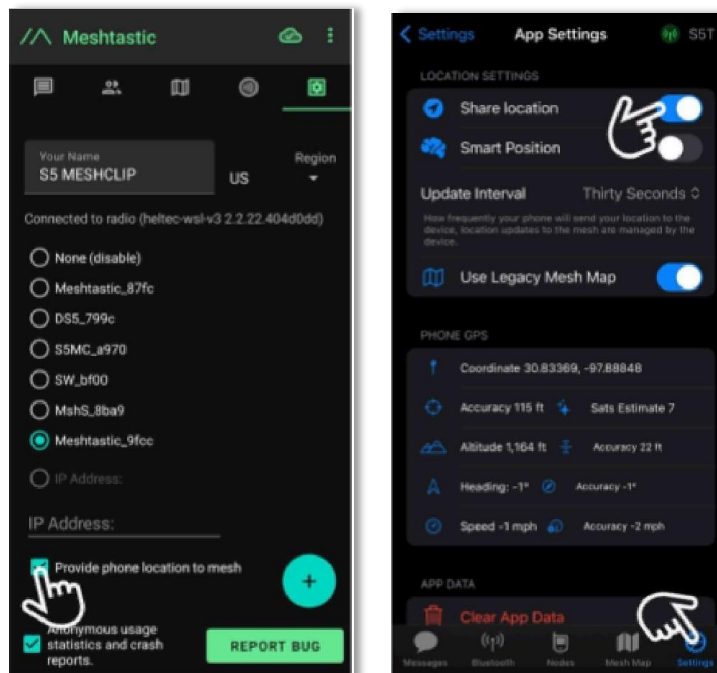

Please refer to the Meshtastic website for any other configuration settings.

Happy Meshing and Thank You from the SpecFive Team!