

S5 MiniTrekker User Guide

Thank you for ordering your S5 MiniTrekker from SpecFive. Here are the instructions to get you connected to your new device and join the mesh.

Button Configuration:

- User Button:



- Single short press with device on:
 - Cycle screens
- Single short press with device off:
 - Turns device on
- Double short press with device on:
 - Sends an ad-hoc ping of the device's position to the network
- Triple short press with device on:
 - Enables/Disables GPS
 - If GPS is disabled, the last screen will display "GPS is disabled":

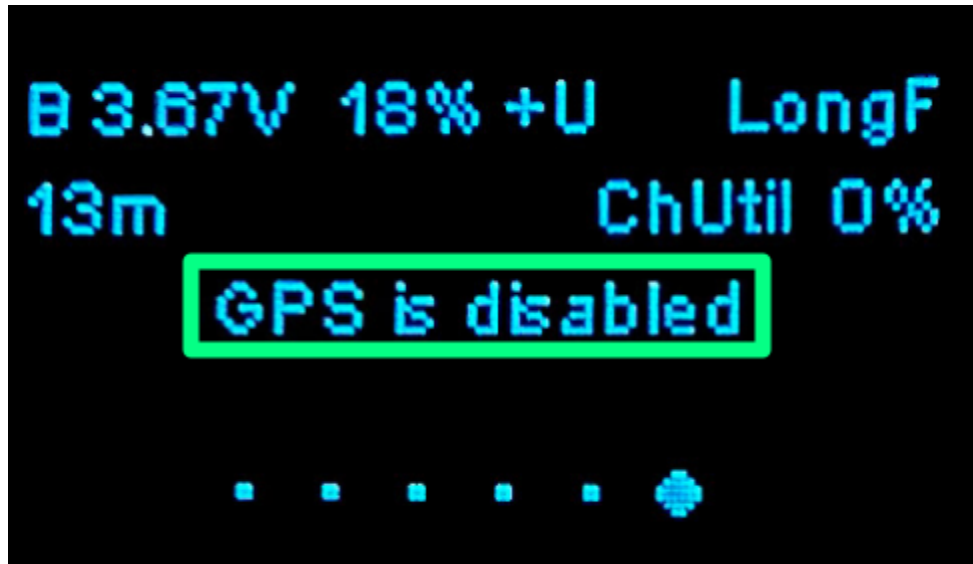

- “No GPS Lock” will be displayed on the final screen if GPS module is on but has not connected to a satellite as seen below:

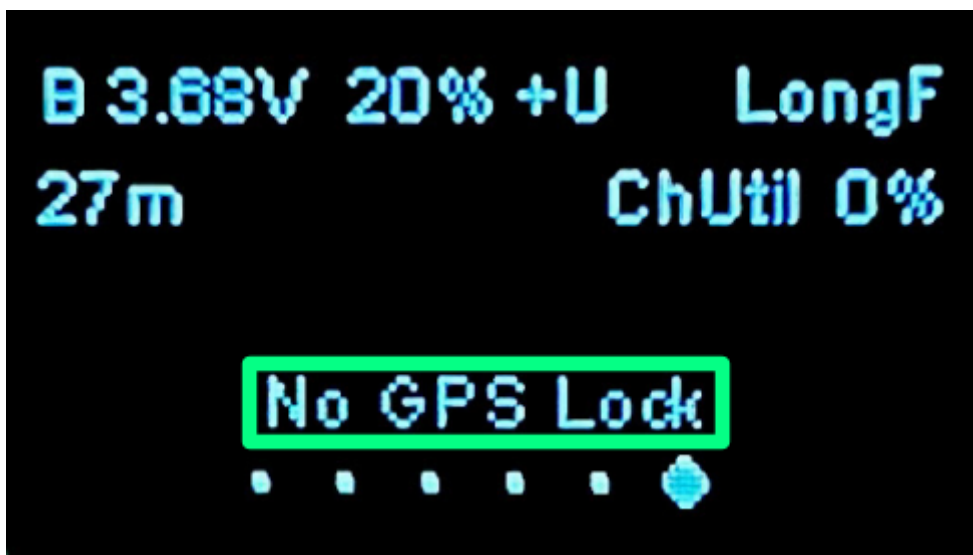

- Long press (5 seconds) with device turned on:
 - Shuts down device
 - Note: The screen should display “Shutting Down...” once the user button has been held down for 5 seconds to indicate the device is shutting down

- Reset Button:



- Single short press:
 - Reboots device

LED Indicators:

- Left LED:
 - Solid Orange:
 - Device is connected to power via usb
- Right LED:
 - Solid White:
 - Device is turning on
 - Flashing White:
 - Device in running

Charging the Device:

- Note: Charging icon should appear in the upper left corner of the second to last screen, shown below, to indicate that the device is powered via usb:



Connecting to the Device via the Meshtastic Mobile App:

1. Download the Meshtastic App from the Apple App Store or Google Play Store



2. Ensure your phone has bluetooth enabled
3. Turn on the device
4. Connect your new Device

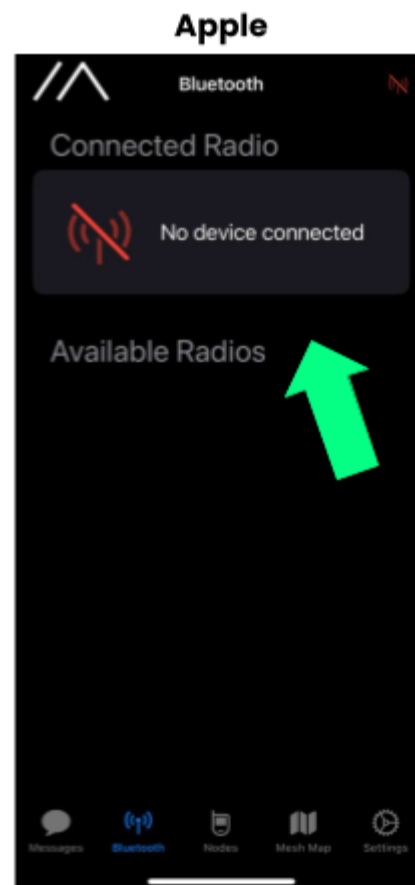
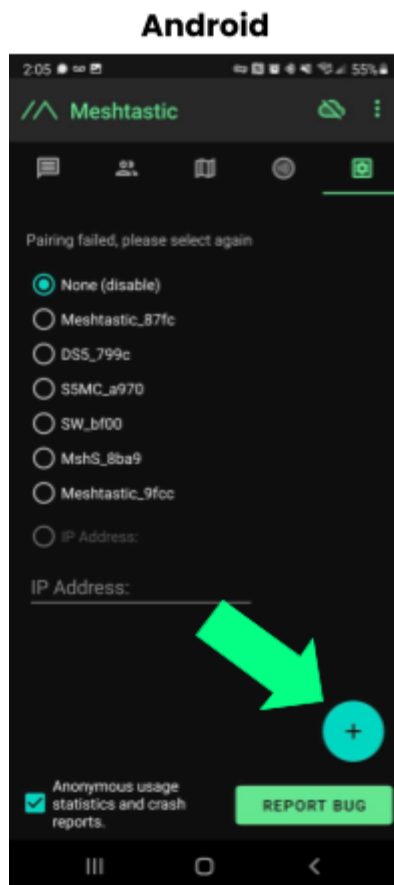

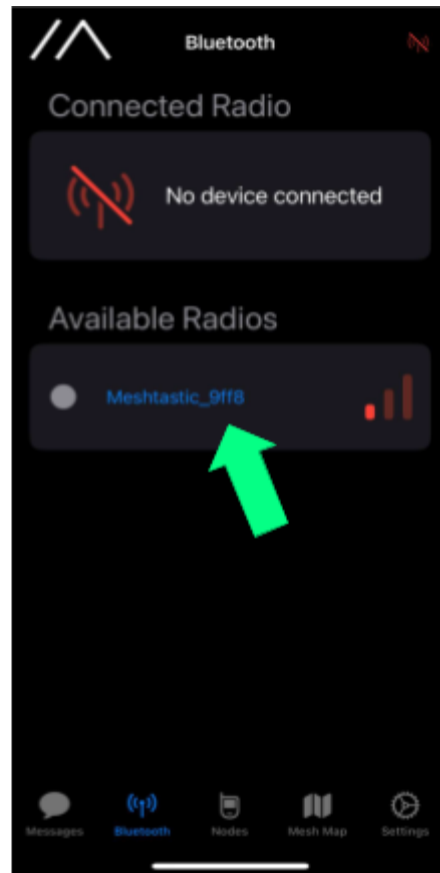
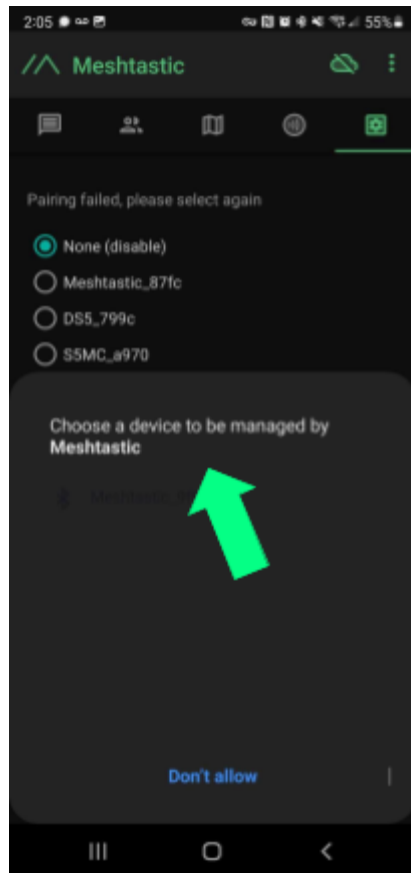

5. Enter the device's pin that is displayed on its screen

You're Good to Go!

Auto Screen Shutdown:

- Device automatically shuts down screen after 10 min. of inactivity
- Device can still send and receive messages
 - Once message is received, the screen will turn back on
- Device is still able to connect a new bluetooth device after 10 min of inactivity

Other Resources:

- For more information on radio configuration settings, visit <https://meshtastic.org/docs/configuration/>
- For more information about our products, visit specfive.com